



RAMNATH  
CONSTRUCTION

# RAMNATH VILLAS

Luxurious 3 Bedroom twin Bungalows  
with Individual stilt parking, open terrace



# STILT PLAN

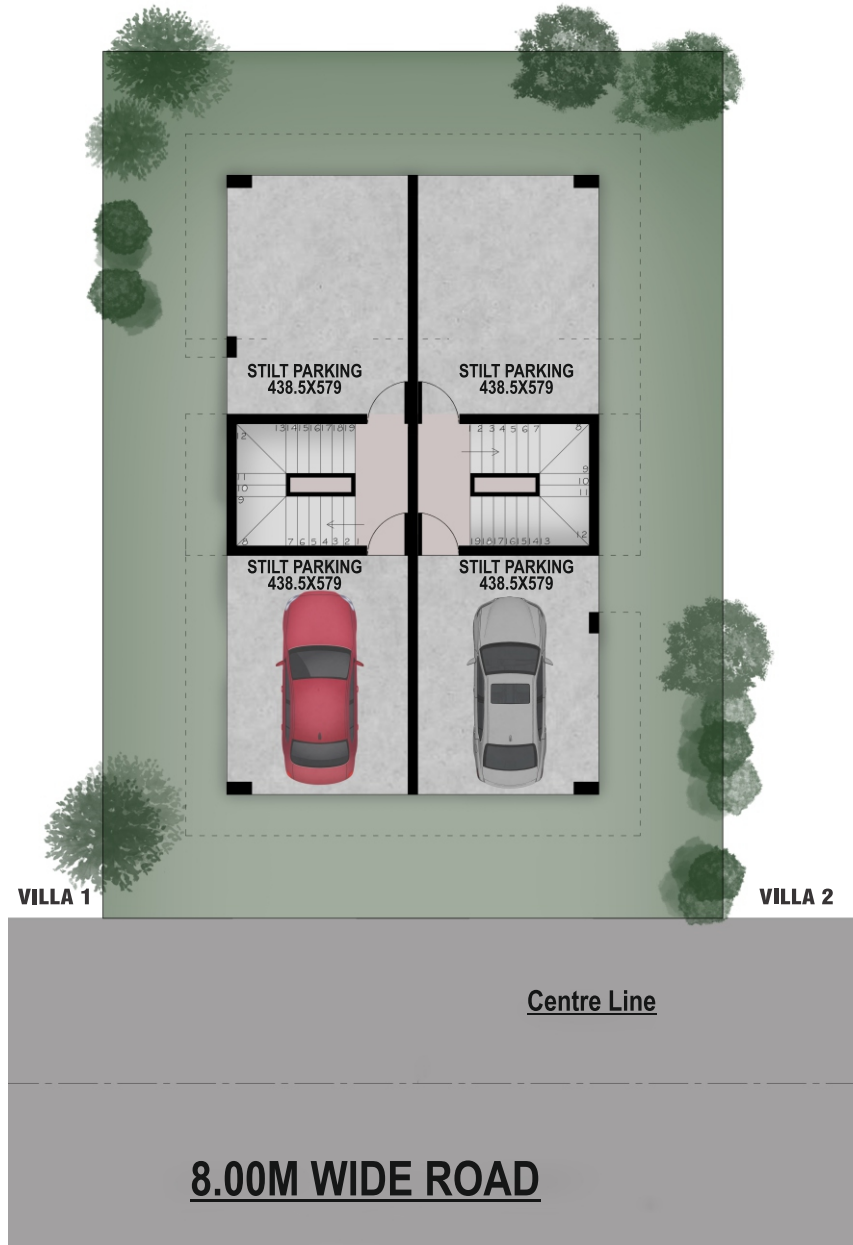

# UPPER GROUND FLOOR PLAN

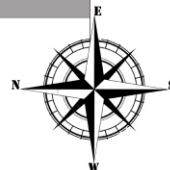

*Luxurious & Spacious*

## FIRST FLOOR PLAN



## OPEN TERRACE FLOOR PLAN



*Enjoy the unique concept of living in style*



**RAMNATH**  
CONSTRUCTION

**403, Edcon Mindspace, Opp. Taj Vivanta,  
Campal, Panaji - Goa.  
TEL: 0832-2425654 / 9422438019**

**Location (Kadamba Plateau)**

5 Kms from Panjim  
17 Kms from Calangute  
Close to School, Super Market & Restaurant  
Lush Green Surrounding

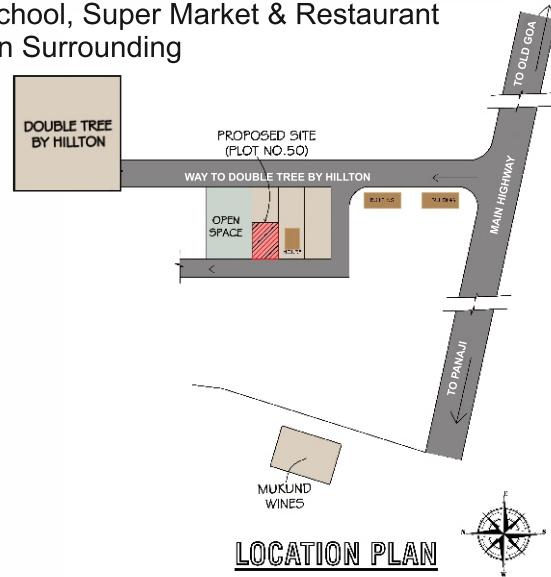

**LOCATION PLAN**

**STRUCTURE**

R.C.C Framed structure of columns, beams, and slabs. Internal partition walls will be 4" brick masonry. External walls will be 8" brick / laterite stone masonry.

**PLASTER**

External plaster will be double coat sand faced cement plaster. Internal plaster will be single coat with a second coat of birla wall care putty or gypsum plaster.

**EXTERNAL DÉCOR**

External walls will be painted with weather shield paint.

**INTERNAL DÉCOR**

Walls will be painted with plastic emulsion. Doors will be Painted / Varnished / French polished.

**FLOORING**

Flooring will be Johnsons vitrified tiles or its equivalent, for the entire villa. Bathroom dado will have floor to ceiling glazed designer tiles with highlighters and good quality ceramic antiskid flooring tiles.

**KITCHEN**

Kitchen will have a cooking platform with black granite top and 60 cm designer tile above the platform. Sink will be stainless steel Nirali or its equivalent.

**DOORS**

Door frames will be made of teak wood and sal wood. Doors will be flush and veneered. Bathroom shutters will be fiber FRP doors.

**WINDOWS**

Windows will be sliding or opening with powder - coated aluminum frames and aluminum fittings.

**PLUMBING AND SANITARY**

Concealed pipes will be of C.P.V.C. pipes with hot and cold system in bathrooms. Sanitaryware will be Hindware or Kohler, or Equivalent. Fittings will be Jaquar or Kohler with single lever diverter or equivalent quality.

**ELECTRICAL INSTALLATION**

Electrical wiring will be Finolex wires or equivalent and will be concealed. All switches will be Legrand moduler switches or equivalent, with three phase electricity connection.

**AC/TV/TELEPHONE POINTS**

All points will be inside the villa with inverter provision.

**SECURITY**

Video Door Calling & CCTV

**ARCHITECTS**

**Sunil. M. Sardesai & Associates**

	AREA	STILT AREA	TOTAL AREA	TERRACE AREA
VILLA - 1	<b>218.50 M2</b>	<b>50.75 M2</b>	<b>269.25 M2</b>	<b>48.50 M2</b>
VILLA - 2	<b>218.50 M2</b>	<b>50.75 M2</b>	<b>269.25 M2</b>	<b>48.50 M2</b>

All illustrations are artist's impressions only. All landscaping features are subject to local authorities' approval. The information contained in this brochure is subject to change as may be required by the authorities. All measurements are approximate. While every reasonable care is taken in providing this information, the developers cannot be held responsible for any inaccuracy.